

CLIFTON ROAD SOUTH

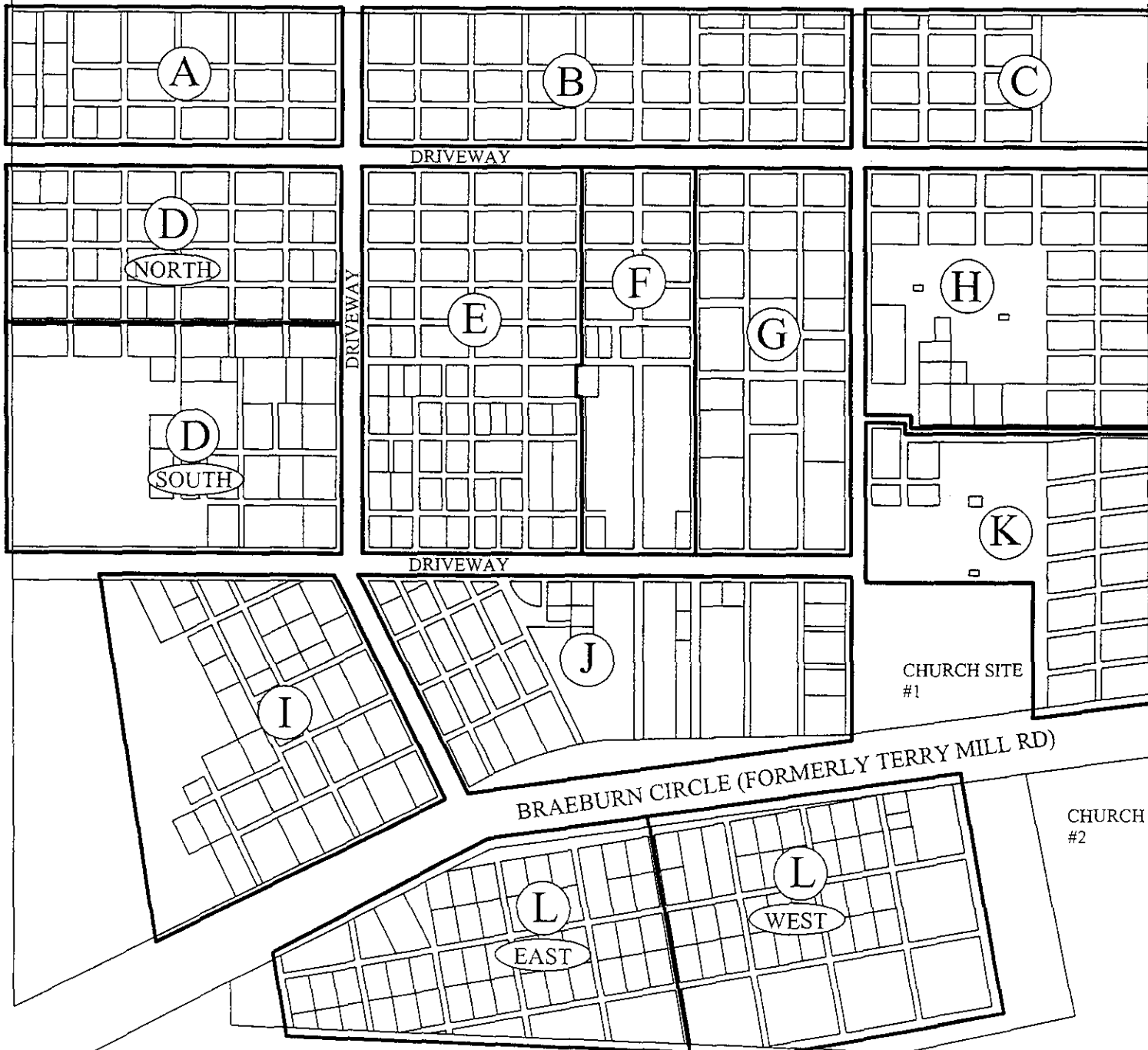

JOSEPHINE

NASH

CHURCH SITE #1

IN THE MID 1800s THIS WAS A ONE ROOM SCHOOLHOUSE DEEDED BY MARY TERRY IN FEBRUARY 1874 TO TRUSTEES FOR SYLVESTER CHAPEL METHODIST EPISCOPAL CHURCH SOUTH. THE CHURCH WAS NAMED AFTER MARY TERRY'S DECEASED SON WHO HAD DIED IN 1872 AT THE AGE OF 15 YEARS. THE METHODIST CHURCH FAILED AND THE SCHOOLHOUSE BECAME KNOWN AS THE SYLVESTER MEETING HOUSE.

CHURCH SITE #1

IN 1883 SYLVESTER BAPTIST CHURCH WAS ORGANIZED ANI USED THE MEETING HOUSE AS IT'S BUILDING OF WORSHIP UNTIL OUTGROWING THE ORIGINAL ONE ROOM SCHOOLHOUSE IN 1887.

CHURCH SITE #2

IN JULY OF 1887 THE CONGREGATION MOVED TO THE NEWLY CONSTRUCTED CHURCH BUILDING ACROSS THE ROAD. THIS PROPERTY WAS GIVEN TO THE CHURCH BY EDWARD A. WERNER. IN FEBRUARY OF 1955 A NEW BUILDING WAS DEDICATED AND THE CHURCH REMAINED UNTIL DISSOLVING IN 1972.

CHURCH SITE #2

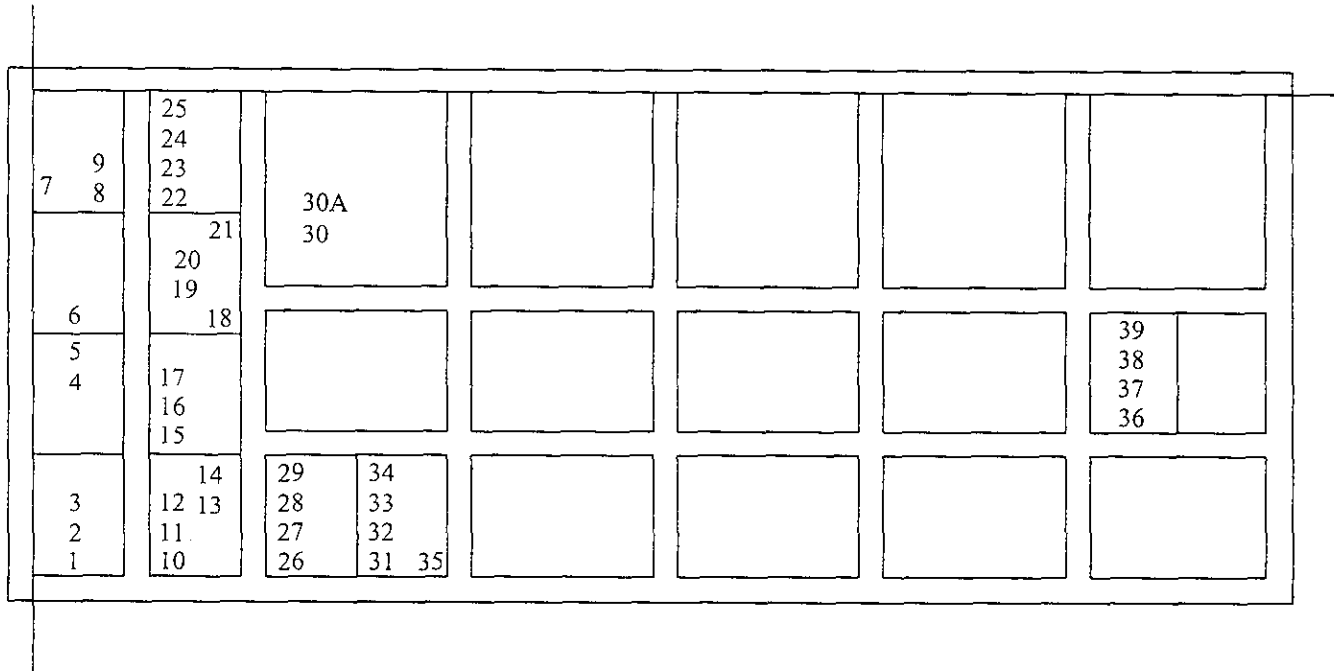

BLOCK A
SYLVESTER CEMETERY

	10 11					48	49	50 51		
	12 13	14	22	23 24	25	26 27	52 53 54 55 56 57	58 59		
6 5 4 3	9 8 7	15	21 20	16	28 29	30	38 37	46	47	
2 1	17 18 19				31 32	36 35 34 33	39 40	42 41	45 44 43	
								60 61	63 62	65 64

BLOCK B
SYLVESTER CEMETERY

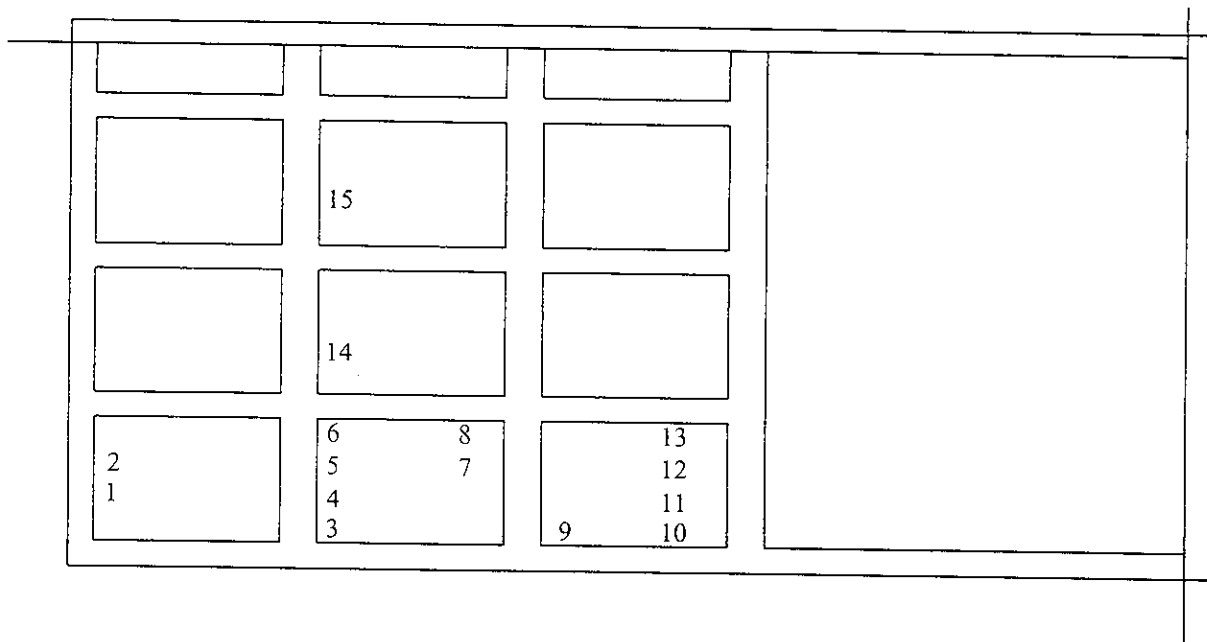

BLOCK C
 SYLVESTER CEMETERY

CLIFTON ROAD SOUTH

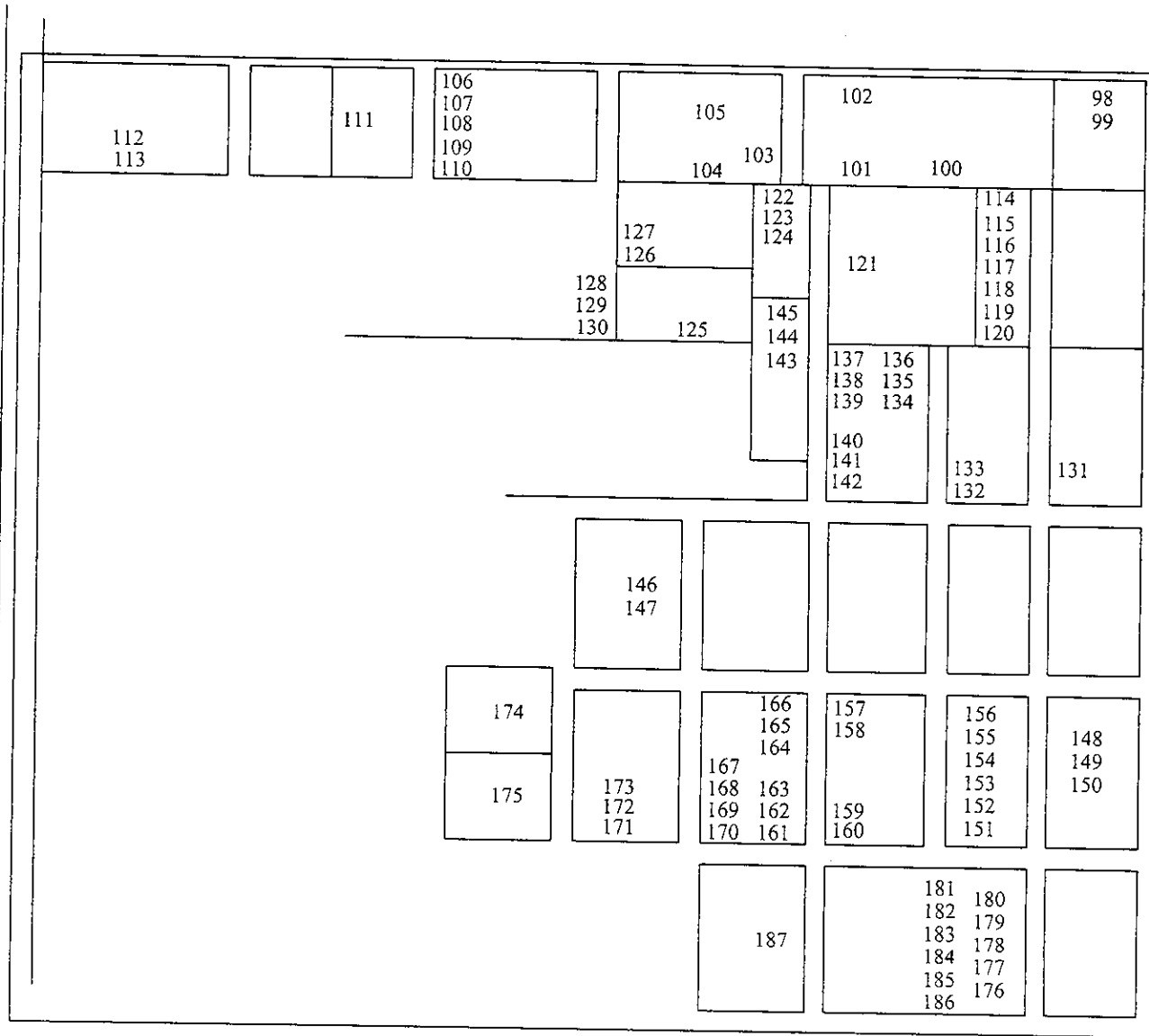

BLOCK D (SOUTH) - SYLVESTER CEMETERY

CLIFTON ROAD SOUTH

	4 3 2 1		8 7 6	11 10 9	12	12.1	15 14 13		
19 18 17	20	25 24 23 22 21	30 29 28 27 26	31 32 33		34 35 36 37 38	39 40 41 42	43 44 45 46	47 48 49
75 74 72 71	73 69 70		64 65 66 67 68		63	61 62	60 58 59	54 56 57	55 50 51 52 53
76 77 78	79	83 82	85 84 86	88 89	90		91 92 93	94 95	96 97

BLOCK D (NORTH) - SYLVESTER CEMETERY

DRIVEWAY

DRIVEWAY

1 6 5	102 103 98 104 99 105 100 106 101 107		119	149 152 150 153 151 154
2 3 4A 4	108 109 110 111			155 156 157 158 159 160
7 8 9 10 11 12 13	14 15 112 114 113 115		120 121 122 123	161 162 163 164 165
17 18 19 20	21 22 23	116	128 124 129 126 127 125	169 170 171 173 168 172 174
	24 25	117	130	180 175 181 176 182 177 183 178 184 179
26	48 49	51 97 50 96 92 95 91 94 93	90	131 132 135 133 136 134
47	30 29 45 46	44	89 88 87 86	137 138 141 139 142 140
40 39 38 37 33 36 32 35 31 34	42 41	43	85	185 186
60B 60C 60D	60A 58 59 60	61 62 63	84 83 82 81	143 146 144 147 145
	64 65 66 67 68 69	74 75 73 76 72 77 71 79 70 78	80	148 193 194 195
				192 188 189

DRIVEWAY

BLOCK E
SYLVESTER CEMETERY

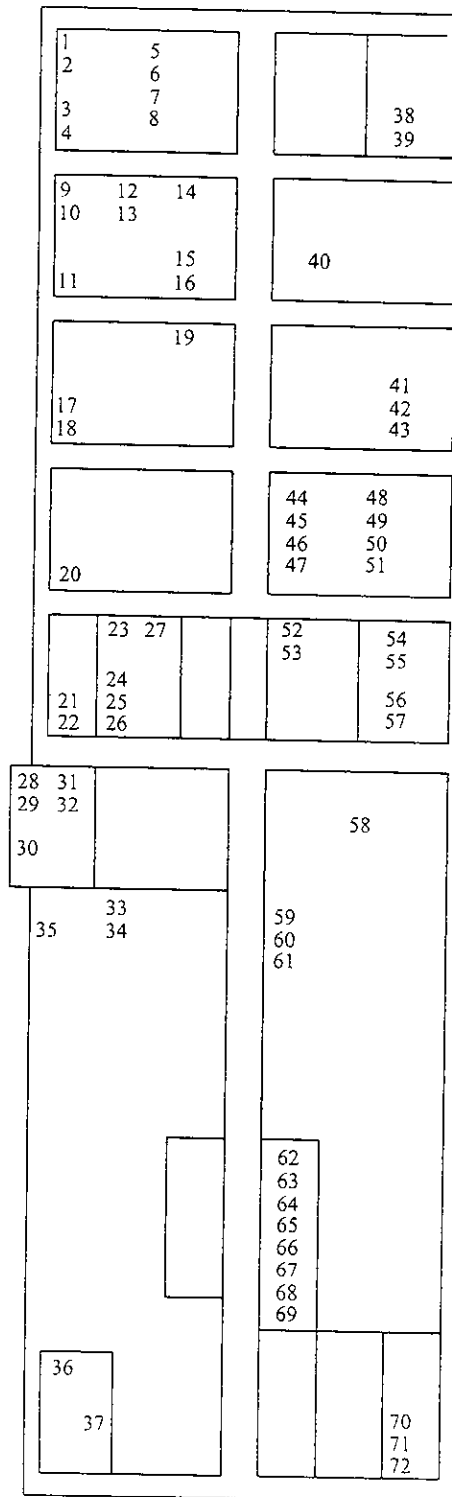

BLOCK F
SYLVESTER CEMETERY

1	42 44 43 45 46	82 83 84
2 3	47 51 48 52 49 53 50	85 86
4 5 6 7	8 10 54 55 56 57 61 58 62 59 63 60 64	87 88 91 89 92 90
11 12 20 13 21 14 15 16 17 22 18 23 19 24	65 66 67 68 69 70 71 72	
25 28 30 26 28 27 29	73 78 74 79 75 80 76 81 77	93 94 95 97 96 99 98 100 101 102
31 32 33 34 35 36		103
37 38 39		104 105
40 41		106 107 108 109

BLOCK G
SYLVESTER CEMETERY

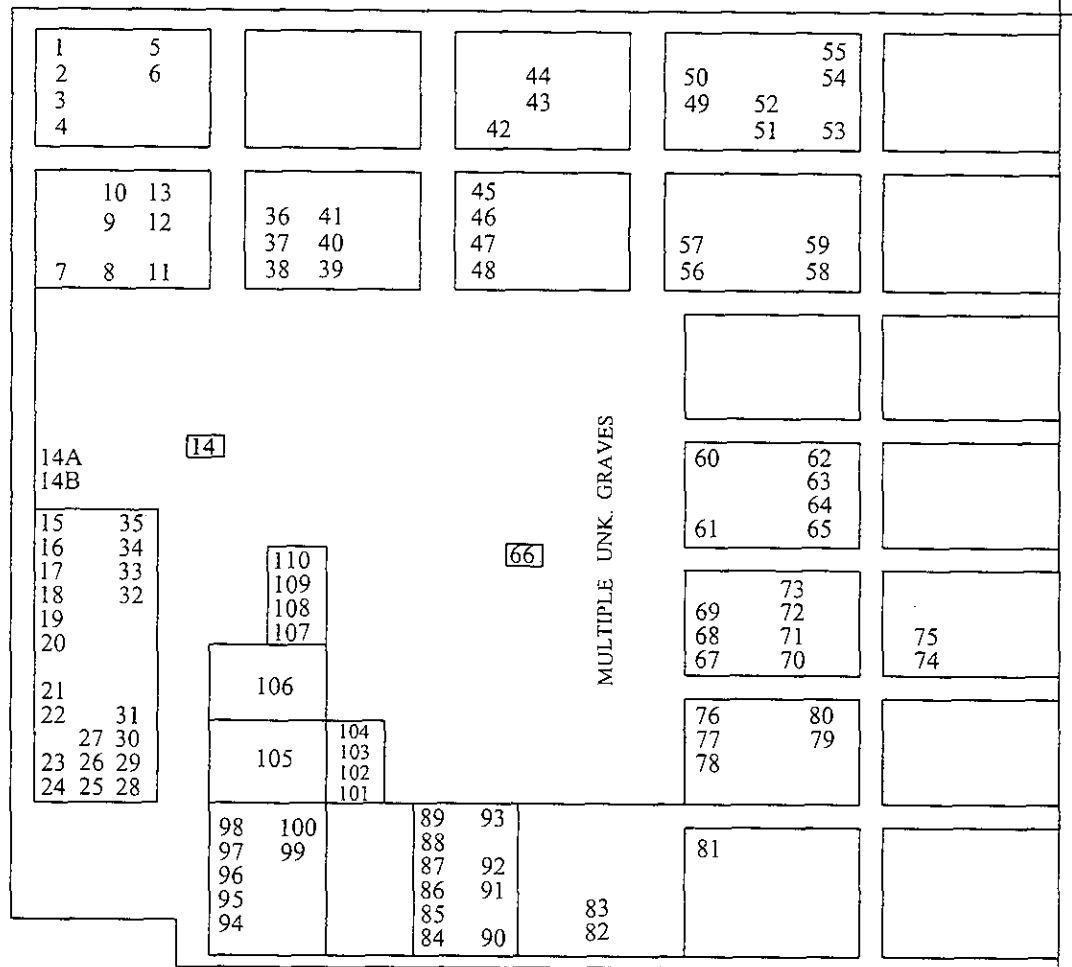

BLOCK H
SYLVESTER CEMETERY

CLIFTON ROAD SOUTH

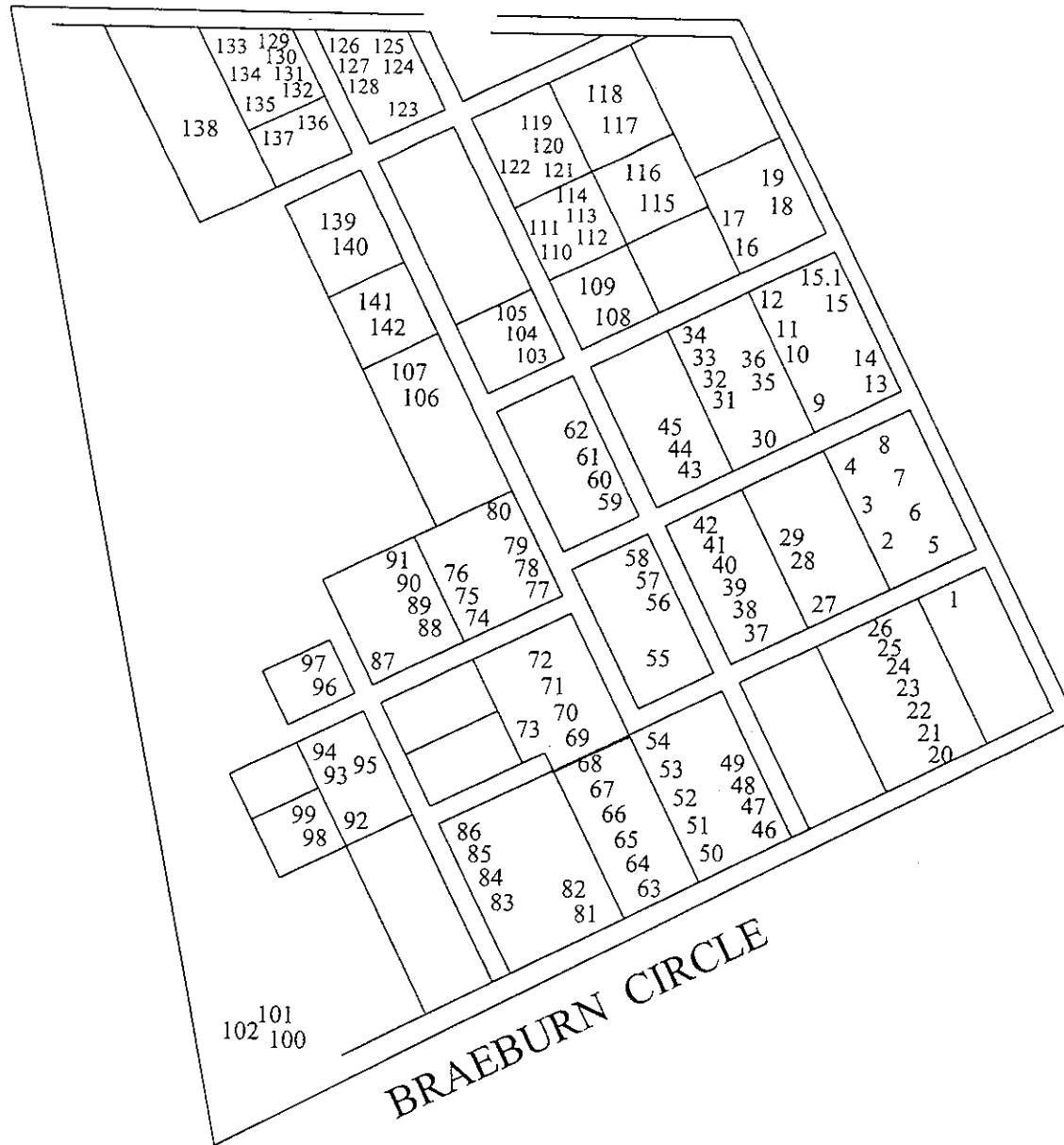

BLOCK I
SYLVESTER CEMETERY

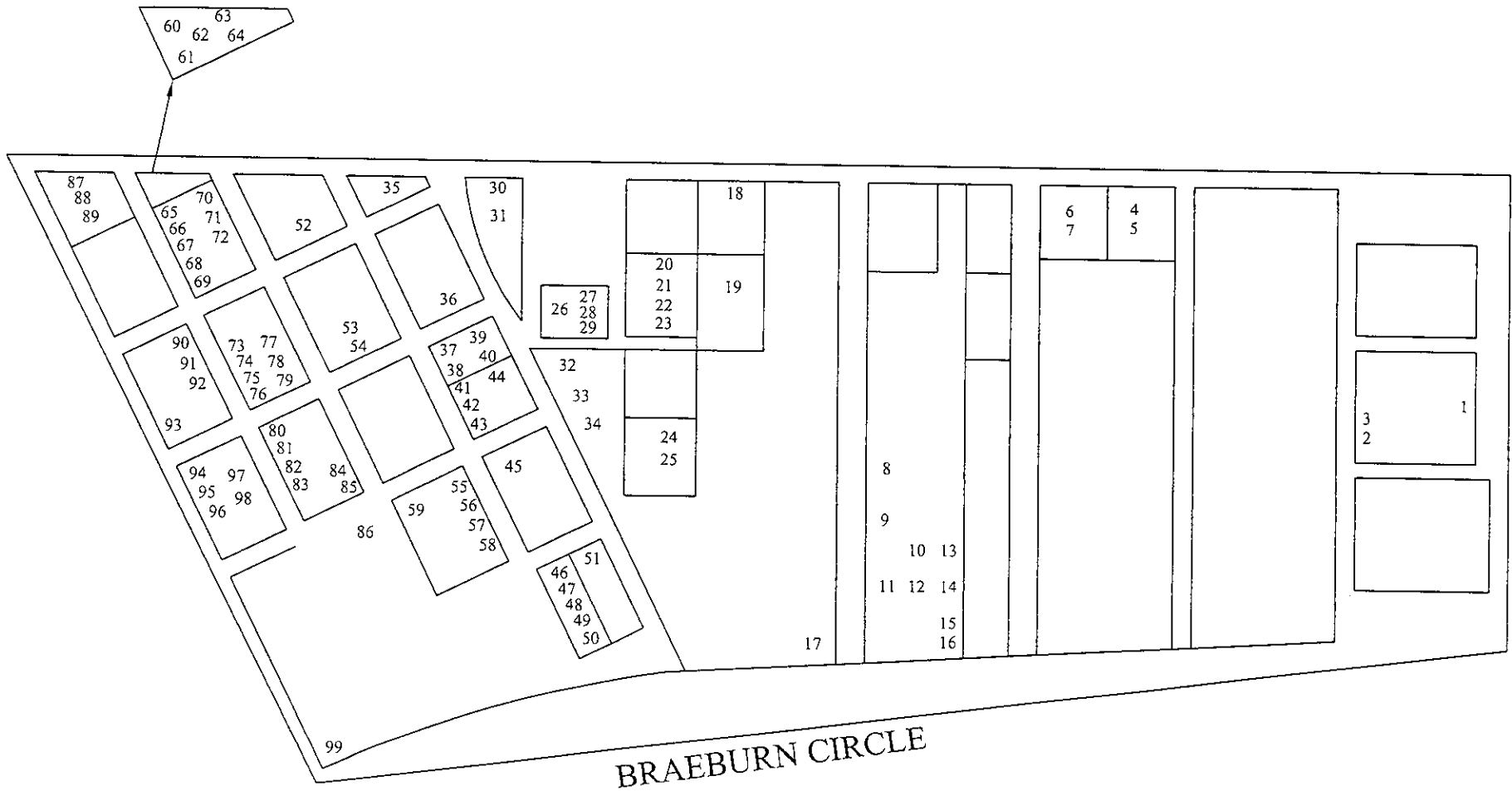

BLOCK J
SYLVESTER CEMETERY

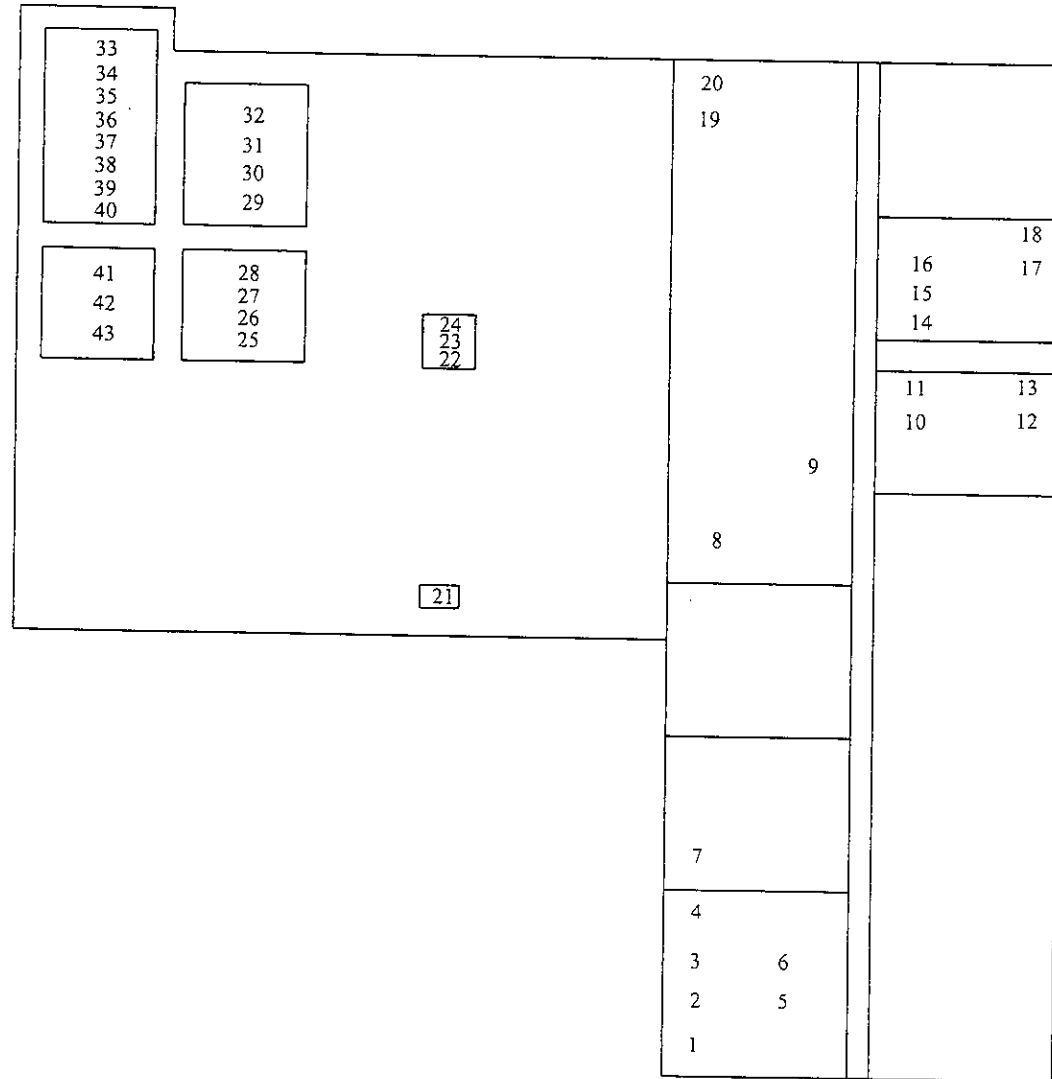

BLOCK K
 SYLVESTER CEMETERY

BRAEBURN CIRCLE

NASH ST



BLOCK L (EAST)- SYLVESTER CEMETERY



BLOCK L (WEST) - SYLVESTER CEMETERY