

City of Virginia Beach

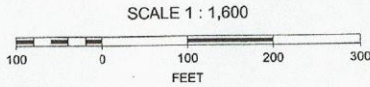

The property known as 4361 Salem Springs Way, has been located on the City's Flood Insurance Rate Map (FIRM) Panel 37E dated December 5, 1996. According to the FIRM, the structure appears to be located in Flood X100, which is not a Special Flood Hazard Area.

Rebecca Lear
 Rebecca Lear
 Office of Beach Management

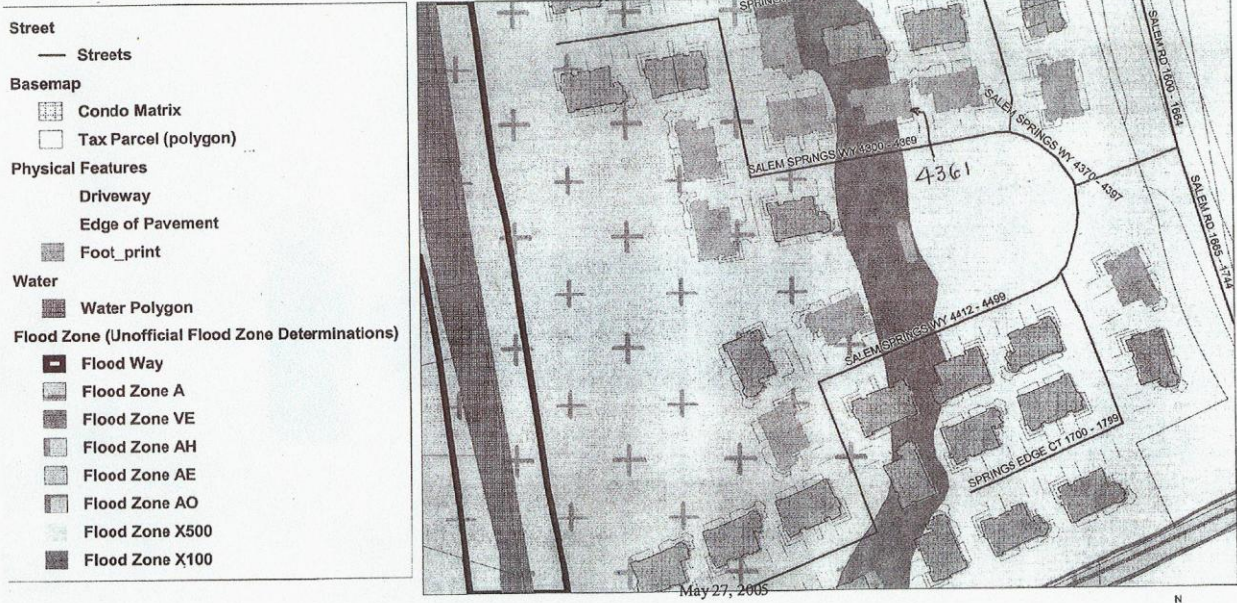