

NOTE: NEIGHBORS TO THE WEST DENIED REQUESTED ACCESS TO OCCUPIED PORTIONS OF PROPERTY THEREFORE THE LOCATION OF SOME STRUCTURES SHOWN IN THIS AREA ARE APPROXIMATE AND MAY BE ENCROACHING

LEGAL DESCRIPTION

PER RECORD OF SURVEY BY BUSH, ROED AND HITCHINGS, INC. DATED 1/2000
 THE NORTH HALF OF THE SOUTHWEST QUARTER OF THE SOUTHWEST QUARTER OF THE SOUTHWEST QUARTER OF SECTION 15, TOWNSHIP 25 NORTH, RANGE 3 EAST, W.M. SITUATE IN KING COUNTY, WASHINGTON

BENCHMARK

CITY OF SEATTLE BENCHMARK NO. 93V-846
 POINT ID 810
 NORTH RIM OF MONUMENT IN CASE AT THE INTERSECTION OF WEST BARRETT STREET AND 44TH AVENUE WEST.
 ELEVATION = 356.07
 NAVD 88

BASIS OF BEARING

NORTH 89°47'31" EAST BETWEEN A FOUND MONUMENT IN CASE LOCATED AT THE INTERSECTION OF ARAPAHOE PLACE WEST AND WEST DRAVUS STREET AND ANOTHER FOUND MONUMENT IN CASE LOCATED AT 39TH AVENUE WEST AND WEST DRAVUS STREET

REFERENCES

RECORD OF SURVEY BY BUSH, ROED AND HITCHINGS DATED 1/2000

NOTES

THIS SURVEY WAS CONDUCTED WITHOUT BENEFIT OF A TITLE REPORT AND THEREFORE DOES NOT PURPORT TO SHOW EASEMENTS OR RESTRICTIONS OF RECORD, IF ANY.

A LEICA TOP703016, 3" INSTRUMENT WAS USED IN OBTAINING ANGLE AND DISTANCE MEASUREMENTS FOR THIS SURVEY. THE DISTANCE MEASURING ABILITIES OF THE INSTRUMENT HAS BEEN COMPARED AT AN N.G.S. BASELINE WITHIN ONE YEAR OF THE DATE OF THIS SURVEY. TRAVERSE CLOSURES ARE IN CONFORMANCE WITH WAC 332-130-030.

CAUTION

LOCATION OF EXISTING UTILITIES SHOWN HAVE BEEN DETERMINED USING FIELD SURVEY DATA AND AVAILABLE RECORD DRAWINGS. IT IS THE CONTRACTOR'S RESPONSIBILITY TO FIELD VERIFY LOCATION OF UTILITIES PRIOR TO PROCEEDING WITH CONSTRUCTION.

LEGEND

- FOUND MONUMENT IN CASE
- FOUND TACK IN LEAD
- SEWER MANHOLE
- SEWER CLEANOUT
- STORM DRAIN MANHOLE
- CATCH BASIN
- WATER MANHOLE
- WATER METER
- WATER VALVE
- HYDRANT
- BLOW OFF
- POWER VAULT
- POWER HAND HOLE
- LUMINAIRE
- AREA LIGHT
- TELECOMMUNICATIONS HAND HOLE
- TELECOMMUNICATIONS VAULT
- TRAFFIC SIGNAL
- UNKNOWN HAND HOLE
- SIGN
- FLAG POLE
- 20" TREE STUMP
- 12" DECIDUOUS TREE
- 12" Y. YELLOW TREE
- 12" BIRCH TREE
- 12" FIR TREE
- CONCRETE WALK
- S — SEWER LINE
- W — WATER LINE
- SD — STORM DRAIN LINE
- T — TELECOMMUNICATIONS LINE
- P — UNDERGROUND POWER LINE
- CH/P — OVERHEAD POWER LINE
- G — GAS LINE
- X — FENCE

RECEIVED
 DEC 02 2005
 DEPT OF PLANNING AND DEVELOPMENT

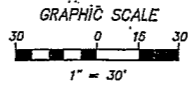

TOPOGRAPHIC SURVEY

BRIARCLIFF REVIVAL
 3801 WEST DRAVUS STREET
 SEATTLE, WASHINGTON

STAMP NOT VALID
 UNLESS SIGNED AND DATED

PETERSON CONSULTING ENGINEERS

4010 Lake Washington Blvd., N.E., Suite 300
 Kirkland, WA 98033
 Tel (425) 827-5074
 Fax (425) 822-7216

DESIGNER: AHS
 CHECKER: RSM
 DATE: 12/05
 FILE NAME: LEXI0002

JOB NUMBER: LEXI0002
 SHEET NUMBER: C3 OF 11

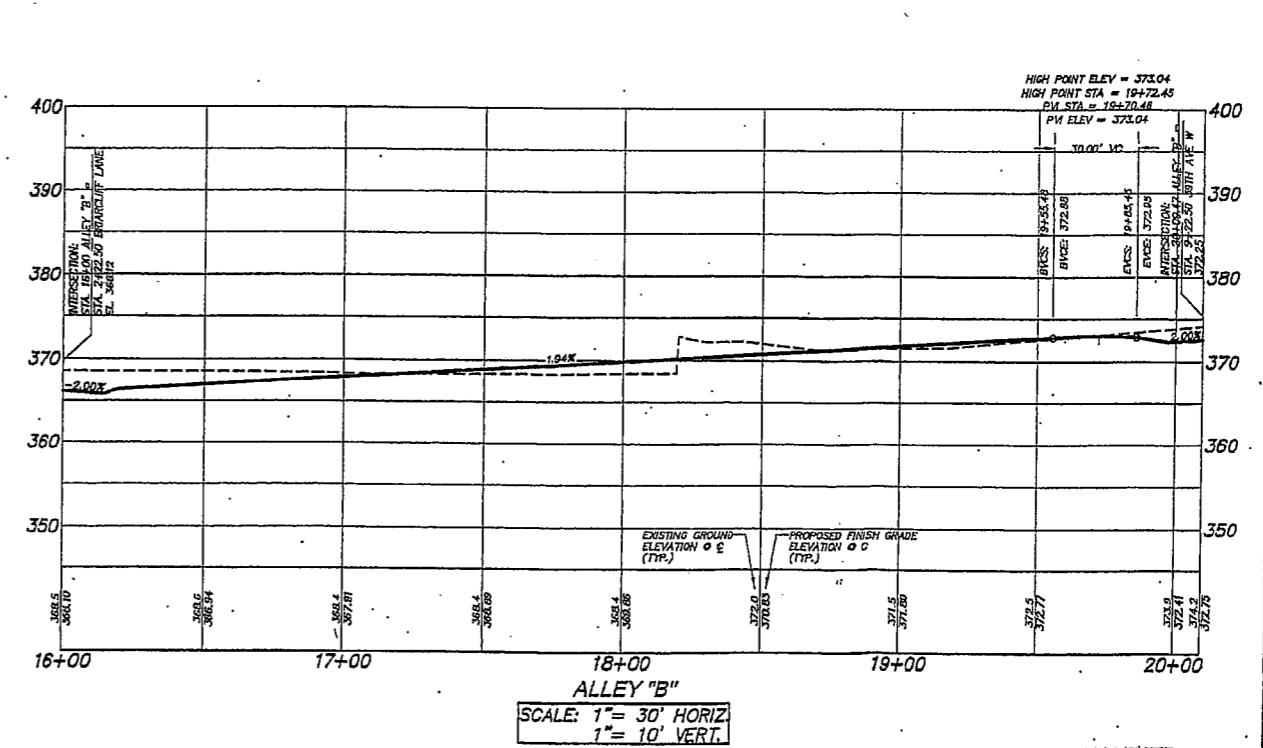
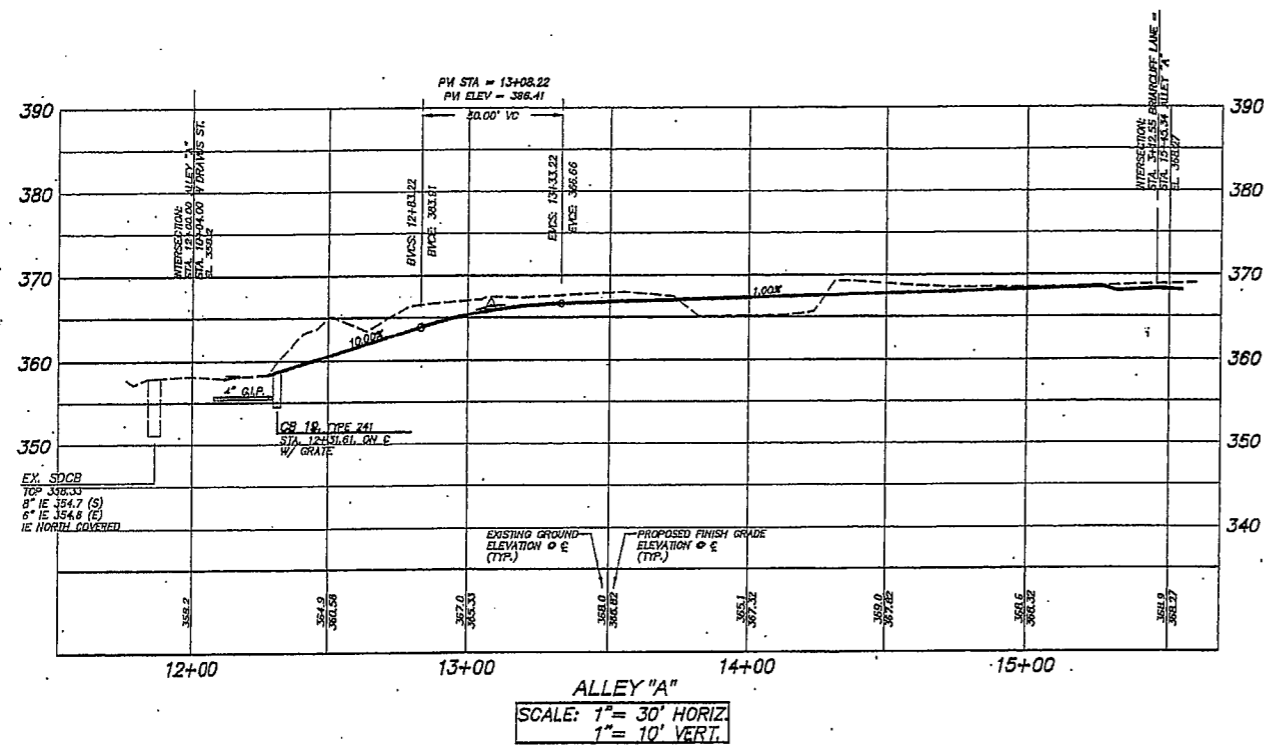
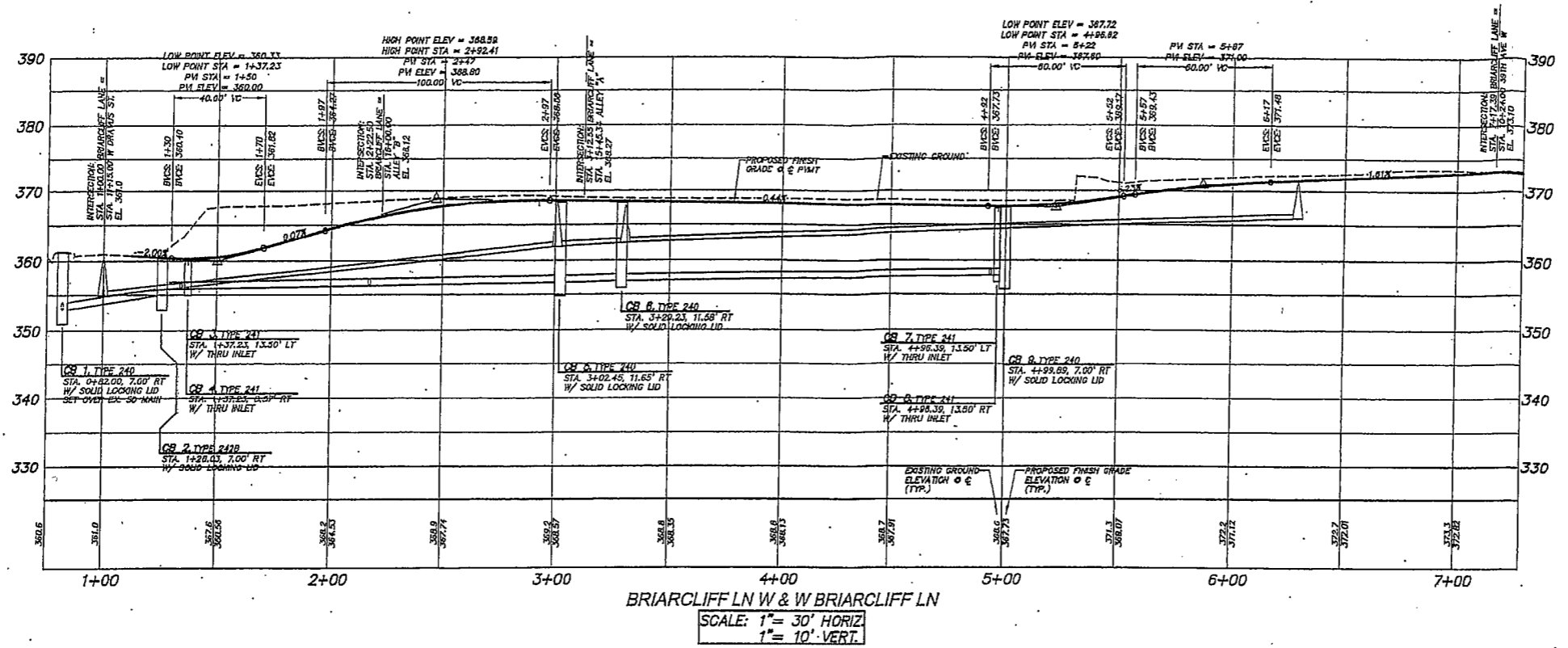

PRELIMINARY ROAD AND STORM DRAINAGE PROFILES

BRIARCLIFF REVIVAL

3801 WEST DRAVUS STREET

WASHINGTON

CITY OF SEATTLE



PETERSON CONSULTING ENGINEERS

4010 Lake Washington Blvd. N.E., Suite 300
Kirkland, WA 98033
Tel (425) 827-5874
Fax (425) 822-7216

RECEIVED
DEC 02 2005
DEPT OF PLANNING AND DEVELOPMENT

JOB NUMBER: LEXI-0002
SHEET NUMBER: C6 OF 11

NO.	DATE	REVISION
1		VALUES REVISED PER CITY COMMENTS
2		VALUES REVISED PER CITY COMMENTS
3		VALUES REVISED PER CITY COMMENTS
4		VALUES REVISED PER CITY COMMENTS
5		VALUES REVISED PER CITY COMMENTS
6		VALUES REVISED PER CITY COMMENTS
7		VALUES REVISED PER CITY COMMENTS
8		VALUES REVISED PER CITY COMMENTS
9		VALUES REVISED PER CITY COMMENTS
10		VALUES REVISED PER CITY COMMENTS

DESIGN GROUP	HAROLD F. PETERSON, P.E.
PROJECT MANAGER	H. PETERSON
DESIGNER	R. GREEN
CADD	H. PETERSON
CHECKER	H. PETERSON
DATE	4/1/04
FILE NAME	8P14E002

P:\Projects\LEXI\0002\0501\0501.dwg, 05/01/2005, 13:25:49, 0.00, 0.00

